

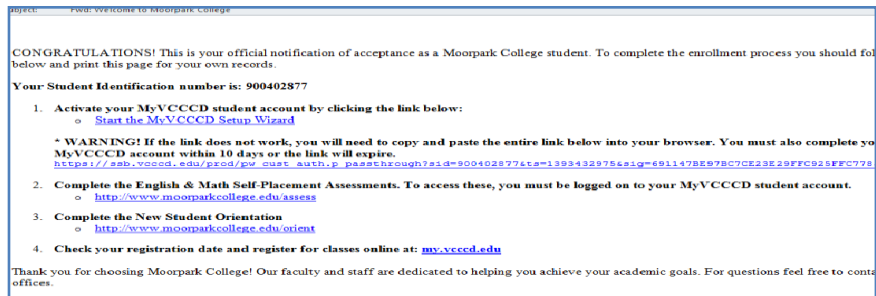

How to Set Up Your "MyVCCCD" Account

After you submit your application - **CHECK YOUR E-MAIL!!!** You will receive a "Welcome to Moorpark College" email. **This e-mail contains a link to the MyVCCCD SET UP PROCESS!! You must use link within 10 days!**



STEP 1:

Use this link to set up your portal account:
Followall of the steps:



STEP 2:

You will be given a college e-mail address **OR** you can choose to have your e-mails forwarded to your personal e-mail.

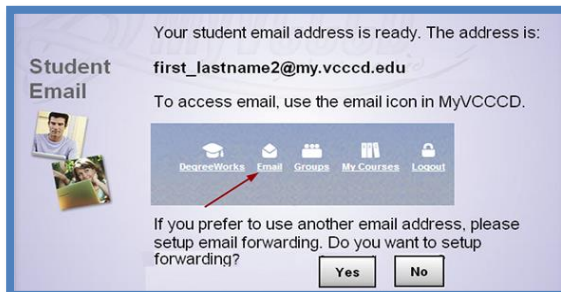

STEP 3:

Enter your forwarding address.

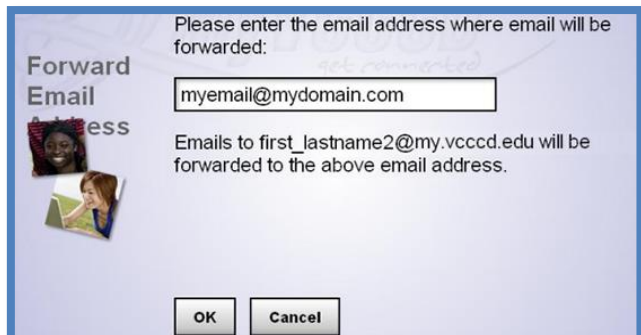

STEP 4:

Read the **PASSWORD** instructions and click "continue".

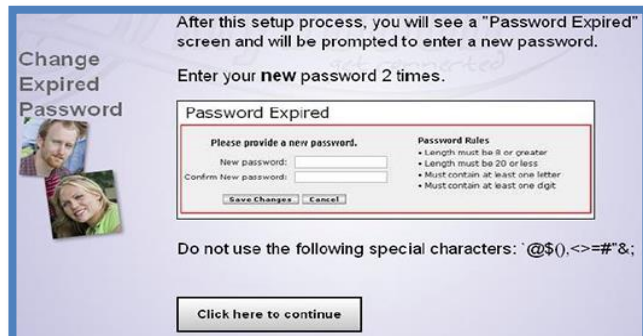

STEP 5:

You are now ready to set up your password. Click on "Create password."

Your MyVCCCD account is ready.

MyVCCCD Ready

Remember your username and MyVCCCD website address. Click the yellow button to set your MyVCCCD password.

Username: first_lastname2
Website: my.vcccd.edu

Create Password

If you encounter a problem, click "I need help."

REMEMBER!
From now on,
do not use
WebSTAR.
Always use
MyVCCCD.

STEP 6:

Choose a **NEW** password. Remember the Password rules. Enter the password twice to confirm it, then "**SaveChanges**". Passwords are case sensitive!

Password Expired

Please provide a new password.

New password:

Confirm New password:

Save Changes **Cancel**

Password Rules

- Length must be 8 or greater
- Length must be 20 or less
- Must contain at least one letter
- Must contain at least one digit
- The password must not contain any of these special characters: '@\$', '<', '>', '#', '&', ''

STEP 7:

Set up your security questions & answers. This will help you reset your account if you forget your password. Print questions & answers before you submit.

| Questions | Answers |
|--|----------------------|
| What was your childhood nickname? | <input type="text"/> |
| What is the name of your favorite childhood friend? | <input type="text"/> |
| What school did you attend for sixth grade? | <input type="text"/> |
| What is the street number of the house you grew up in? | <input type="text"/> |
| To what city did you take your first airplane trip? | <input type="text"/> |

Submit Setup **Cancel**

STEP 8:

Congratulations! You may now log into your **MyVCCCD**.

MyVCCCD (2013-2014)

Username

Password

Login

Forgot username? Forgot password?

Sign up for an account **Sign up and Log in help**

Student Support **Faculty Support**

If you have any questions about the application, you can contact
Outreach Department at 805-378-1409